



# PS CONNECTOR

- 可靠的锁定功能和低接插力
- 稳定的接触性能
- 防误插构造和塑壳端点锁扣
- 接片防误插机构（防短路塑壳型）
- 防短路塑壳型中还有灼热丝对应产品阵容

## ■登录标准

UL:Recognized E 60389

CSF:Certified LR 20812

IEC:R9850196

## ■一般规格

- 额定电流：25A AC/DC（使用 #250 接片 /AWG#10 时）
  - 额定电压：250V AC/DC
  - 使用温度范围：-40℃～+105℃（含通电时的温度上升值）
  - 接触电阻：初期 /3mΩ 以下  
环境试验后 /6mΩ 以下
  - 绝缘电阻：1,000MΩ 以上
  - 耐电压：AC 2,000V/1 分钟
  - 适用电线范围：#110/AWG#24～#16 #187/AWG#26～#14  
#205/AWG#22～#14 #250/AWG#22～#10
  - 适合的接片：#110 接片 /0.5t #187 接片 /0.5t、0.8t  
#205 接片 /0.5t、0.8t #250 接片 /0.8t
- ※ 使用 PS-250-G（防短路塑壳型）的灼热丝对应产品时，请垂询本公司。  
 ※ 使用时，请参阅卷首的“端子 / 连接器”使用注意事项。  
 ※ 详情请垂询本公司。  
 ※ 介绍了符合 RoHS 标准的产品。

## ■端子

### #110 系列

#### SPS-01T-110

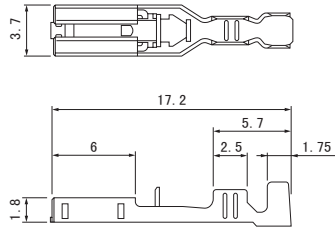

#### SPS-41T-110

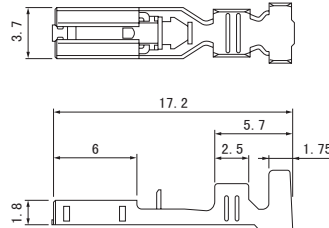

### #187 系列

#### SPS-01T-187

（适用 0.5mm 接片）

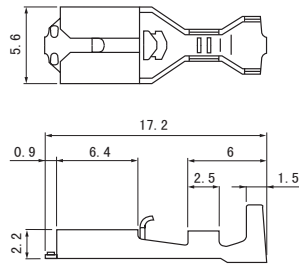

#### SPS-51T-187

（适用 0.5mm 接片）

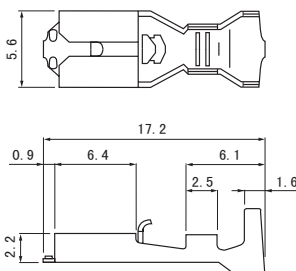

#### SPS-82T-187

（适用 0.5mm 接片）

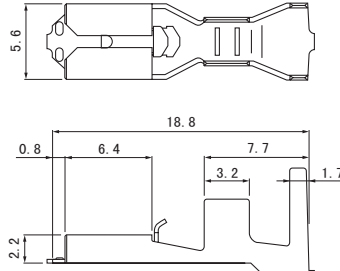

#### SPS-01T-187-8

（适用 0.8mm 接片）

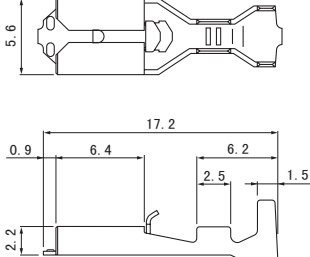

#### SPS-51T-187-8

（适用 0.8mm 接片）

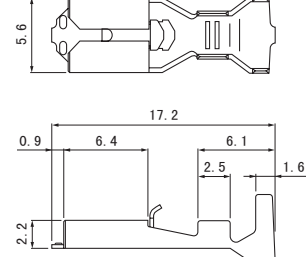

### ●旗型

#### SFPS-41T-187

（适用 0.5mm 接片）

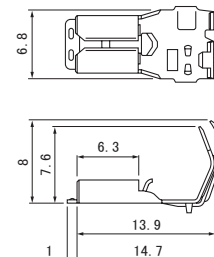

#### SFPS-41T-187-8

（适用 0.8mm 接片）

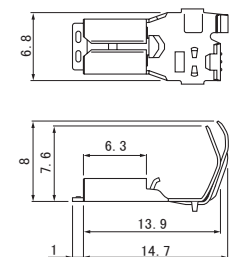

注）#187 系列具有 0.5mm 和 0.8mm 接片用端子。

# PS CONNECTOR

端子

## #205系列

**SPS-21T-205**  
(适用0.8mm接片)

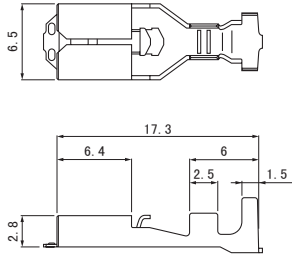

**SPS-21T-205-5**  
(适用0.5mm接片)

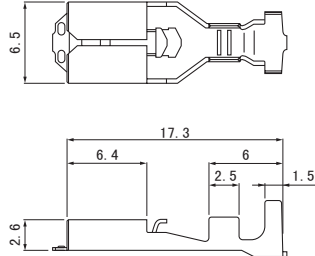

**SPS-51T-205**  
(适用0.8mm接片)

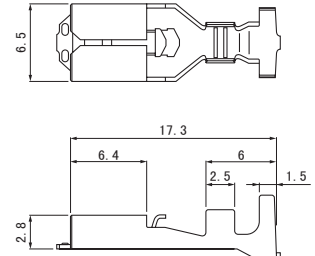

## #250系列

**SPS-21T-250**

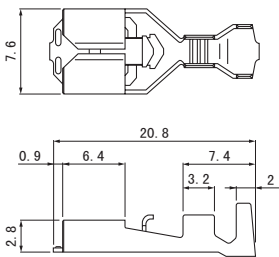

**SPS-61T-250**

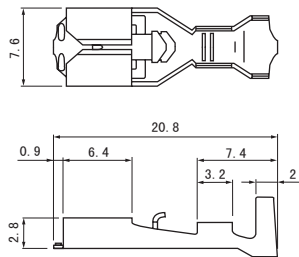

**SPS-91T-250**

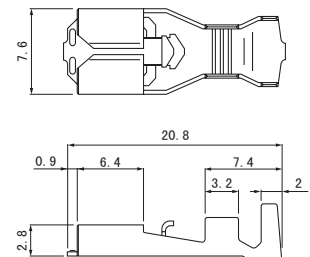

## ●防短路塑壳型

**SPS-21T-250R**

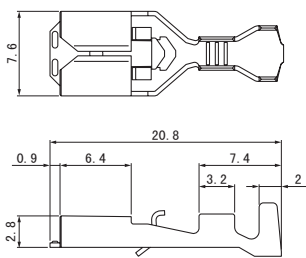

**SPS-61T-250R**

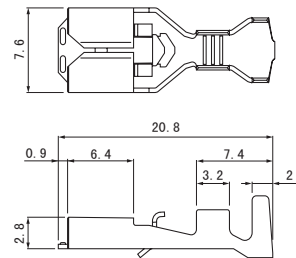

**SPS-91T-250R**

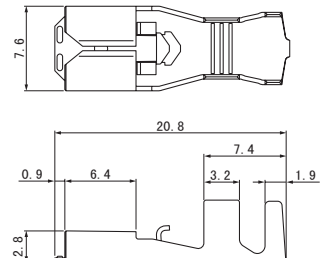

## ●旗型

**SFPS-61T-250**

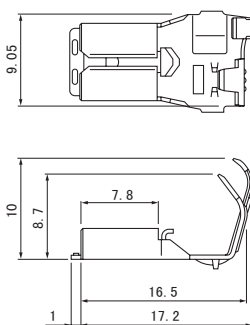

**SFPS-91T-250**

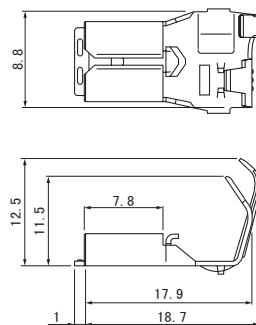

注) #205系列具有0.5mm和0.8mm接片用端子。

# PS CONNECTOR

## 端子

### #250S系列

#### SPS-21T-250S

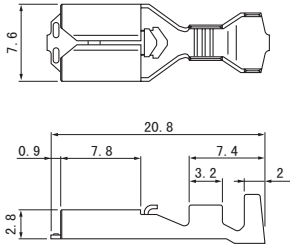

#### SPS-61T-250S

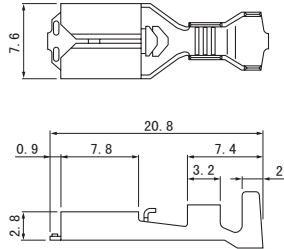

#### SPS-91T-250S

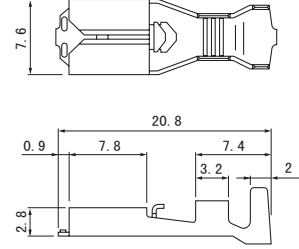

系列名	型号	适用电线范围		电线外皮外径 (mm)	数量/卷
		mm <sup>2</sup>	AWG #		
#110	SPS-01T-110	0.21~0.5	24~20	1.0~2.5	10,000
	SPS-41T-110	0.5~1.31	20~16	1.9~3.4	10,000
#187	适用0.5mm接片 SPS-01T-187	0.13~0.5	26~20	1.3~3.4	10,000
	SPS-51T-187	0.5~2.0	20~14	1.9~3.6	7,500
	※SPS-82T-187	0.75+0.75~1.25+1.25	18+18~16+16	2.1+2.1~2.9+2.9	3,500
	适用0.8mm接片 SPS-01T-187-8	0.13~0.5	26~20	1.3~3.4	10,000
#187 旗型	适用0.5mm接片 SFPS-41T-187	0.3~1.25	22~16	1.7~3.4	5,000
	适用0.8mm接片 SFPS-41T-187-8	0.3~1.31	22~16	1.7~3.4	5,000
#205	适用0.5mm接片 SPS-21T-205	0.3~0.75	22~18	1.5~3.1	5,000
	适用0.5mm接片 SPS-21T-205-5	0.3~0.75	22~18	1.5~3.1	5,000
	适用0.8mm接片 SPS-51T-205	0.5~2.0	20~14	1.9~3.6	5,000
#250	SPS-21T-250	0.3~0.75	22~18	1.5~3.1	5,000
	SPS-21T-250R	0.3~0.75	22~18	1.5~3.1	3,500
	SPS-61T-250	0.75~2.0	18~14	2.1~3.9	5,000
	SPS-61T-250R	0.75~2.0	18~14	2.1~3.9	3,500
	SPS-91T-250	2.0~5.5	14~10	3.0~4.7	4,000
	SPS-91T-250R	2.0~5.5	14~10	3.0~4.7	3,500
#250 旗型	SFPS-61T-250	0.75~2.0	18~14	2.1~3.9	3,000
	SFPS-91T-250	3.5~5.5	12~10	4.0~5.2	2,000
#250S	SPS-21T-250S	0.3~0.75	22~18	1.5~3.1	5,000
	SPS-61T-250S	0.75~2.0	18~14	2.1~3.9	5,000
	SPS-91T-250S	2.0~5.5	14~10	3.0~4.7	4,000

### 材质、表面处理

黄铜、镀锡(回流焊处理)

●符合 RoHS 标准的产品

※表示未注册 CSA、TUV 标准的产品。

端子	压着机	压着模具		
		压着模具主体	刀刃	压着模具套件
SPS-01T-110	AP-K2N	MK-L-SPS	MK/SPS-01-110	APLMK SPS01-110
		—	—	—
SPS-41T-110		MK-L-SPS	MK/SPS-41-110	APLMK SPS41-110
		—	—	—
SPS-01T-187(-8)		MK-L-SPS	MK/SPS-01-187	APLMK SPS01-187
		—	—	—
SPS-51T-187(-8)		MK-L-SPS	MK/SPS-51-187	APLMK SPS51-187
		—	—	—
SPS-82T-187		MK-L-SPS	MK/SPS-82-187	APLMK SPS82-187
		—	—	—
SFPS-41T-187(-8)		MKF-L-PS187	MK/SFPS-41-187	APL SFPS41-187
		—	—	—
SPS-21T-205(-5)	MK-L-SPS	MK/SPS-21-205	APLMK SPS21-205	
	—	—	—	
SPS-51T-205	MK-L-SPS	MK/SPS-51-205	APLMK SPS51-205	
	—	—	—	

端子	压着机	压着模具		
		压着模具主体	刀刃	压着模具套件
SPS-21T-250(S)	AP-K2N	MK-L-SPS	MK/SPS-21-250	APLMK SPS21-250
		—	—	—
SPS-21T-250R		MK-L-SPS	MK/SPS-21-250R	APLMK SPS21-250R
		—	—	—
SPS-61T-250(S)		MK-L-SPS	MK/SPS-61-250	APLMK SPS61-250
		—	—	—
SPS-61T-250R		MK-L-SPS	MK/SPS-61-250R	APLMK SPS61-250R
		—	—	—
SPS-91T-250(S)		MK-L-SPS	MK/SPS-91-250	APLMK SPS91-250
		—	—	—
SPS-91T-250R		MK-L-SPS	MK/SPS-91-250R	APLMK SPS91-250R
		—	—	—
SFPS-61T-250	MKF-L-PS250	MK/SFPS-61-250	APL SFPS61-250	
	—	—	—	
SFPS-91T-250	MKF-L-PS9250	MK/SFPS-91-250	APL SFPS91-250	
	—	—	—	

注) 有关全自动压着机用的压着模具, 请垂询本公司。

# PS CONNECTOR

塑壳

#110系列

PS-110

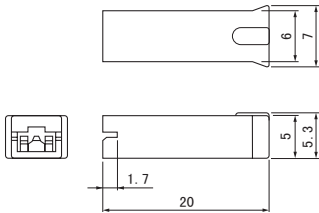

#187系列

PS-187

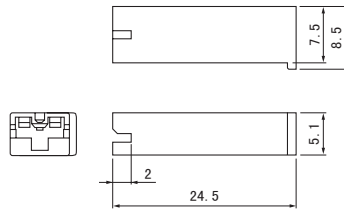

PS-187-2A-10

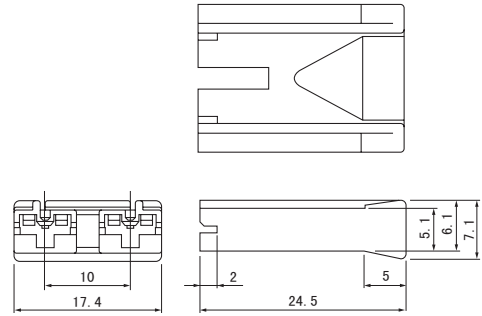

#187系列

PS-187-2A-14

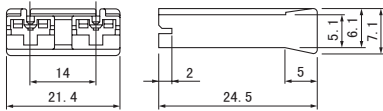
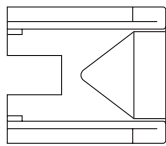

PS-187-2A-15

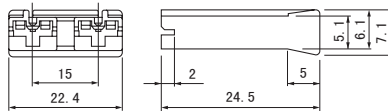
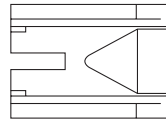

PS-187-2A-17.8

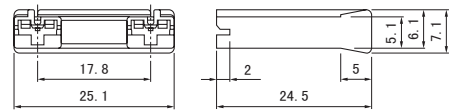
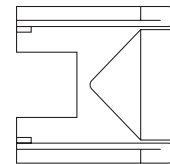

PS-187-2B

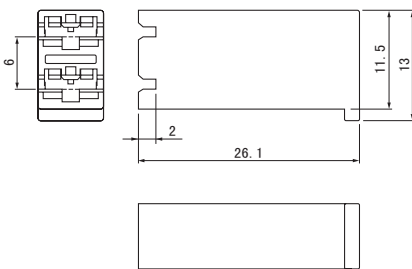

PS-187-2B-6.75

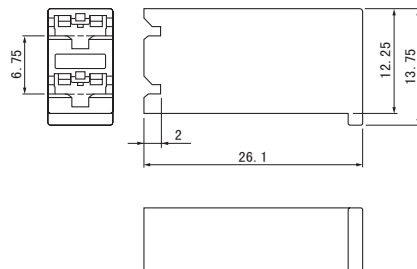

PS-187-2B1

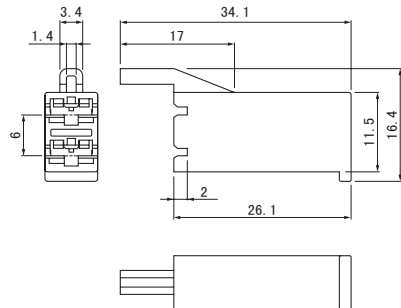

PS-187-4B

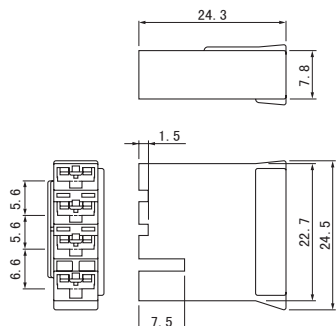

PS-187-2V

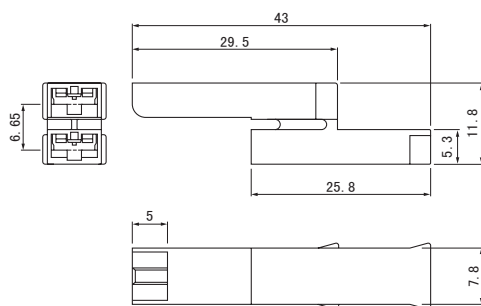

PS-187-3V

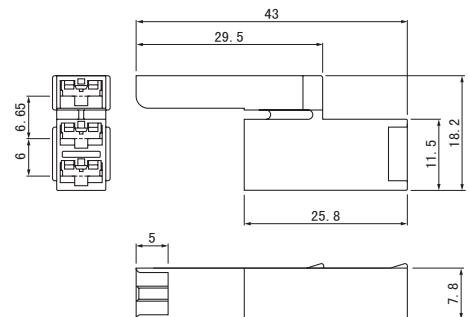

## 塑壳

### #187系列

**PS-187-8-H**

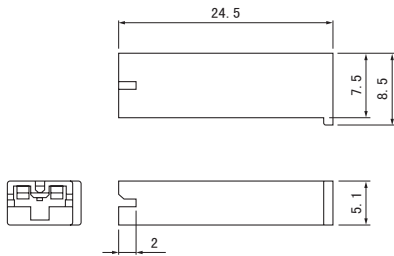

**PS-187-2B1-8-H**

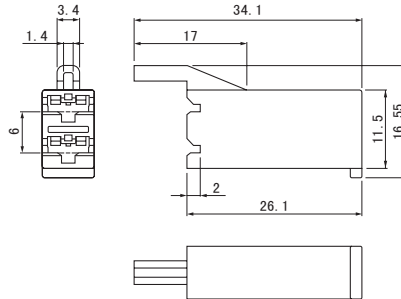

### #250系列

**PS-250**

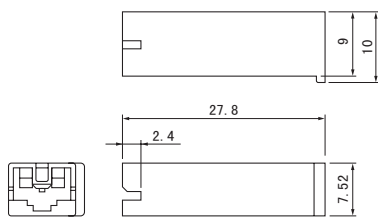

**PS-250-A**

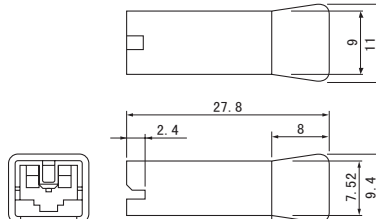

**PS-250-2B**

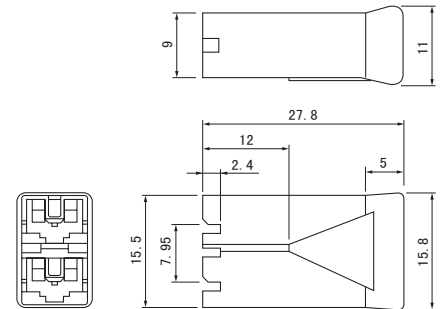

**PS-250-2A-15**

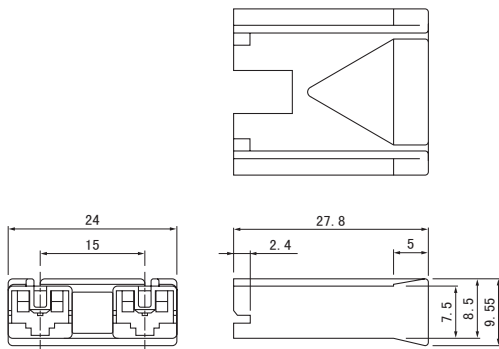

●防短路塑壳型

**PS-250-G (-WGJ2)**

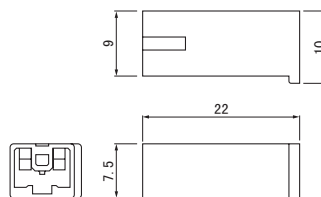

**PS-250-GL**  
(薄型产品)

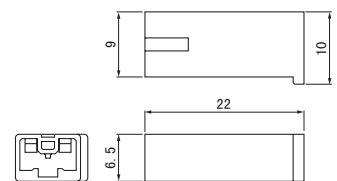

### #250S系列

**NPS-250-A**

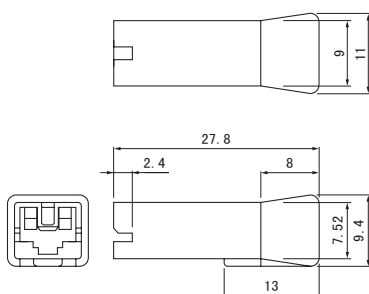

# PS CONNECTOR

塑壳

快接套管

FPS-187

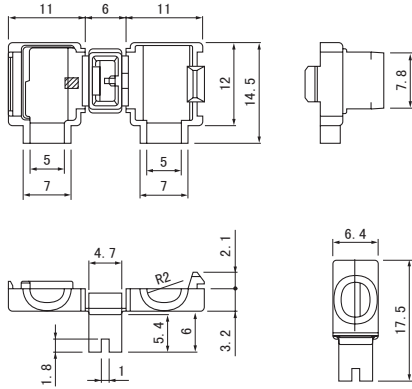

FPS-250

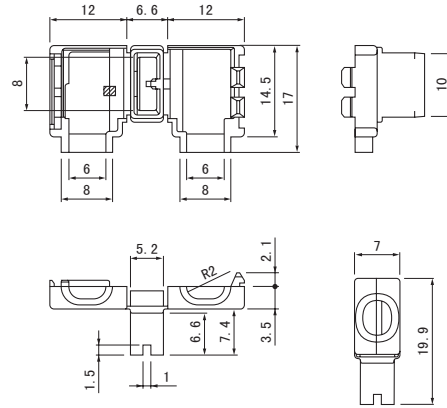

系列名	型号	数量/袋	适合的端子	
#110	PS-110	1,000	SPS-01T-110, SPS-41T-110	
#187	PS-187	1,000	SPS-01T-187 SPS-51T-187 SPS-82T-187	
	PS-187-2A-10	500		
	PS-187-2A-14	500		
	PS-187-2A-15	500		
	PS-187-2A-17.8	500		
	PS-187-2B	500		
	PS-187-2B-6.75	500		
	PS-187-2B1	500		
	PS-187-4B	500		
	PS-187-2V	500		
	PS-187-3V	500		
	PS-187-8-H	注		1,000
PS-187-2B1-8-H	注	500	SPS-51T-187-8	
#250	PS-250	1,000	SPS-21T-250 SPS-61T-250 SPS-91T-250	
	PS-250-A	500		
	PS-250-2B	500		
	PS-250-2A-15	500		
	PS-250-G	1,400		SPS-21T-250R
	PS-250-GL	1,400		SPS-61T-250R
PS-250-G-WGJ2 (灼热丝对应产品)	1,400	SPS-91T-250R		
#250S	NPS-250-A	1,000	SPS-21T-250S SPS-61T-250S SPS-91T-250S	
快接套管	※ FPS-187	500	SFPS-41T-187	
	※ FPS-250	500	SFPS-61T-250	

## 材质

尼龙66、UL94V-0，天然色（白色）  
UL94V-0，灰色（标记 0.8mm 接片用）  
尼龙6、UL94V-2，天然色（白色）（灼热丝对应产品）

●符合RoHS标准的产品

※表示未注册 :Recognized E55167, :Certified LR83372, TÜV标准的产品。

## 适用接片

### #110

接片厚度 0.5mm

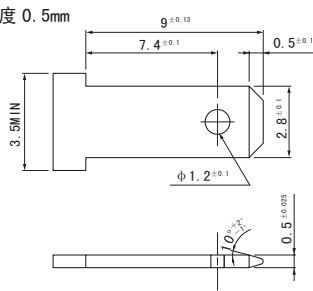

### #187

接片厚度 0.5mm

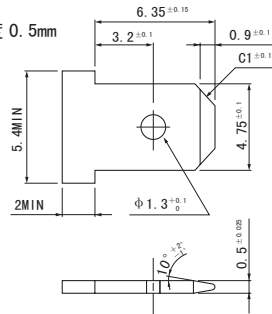

接片厚度 0.8mm

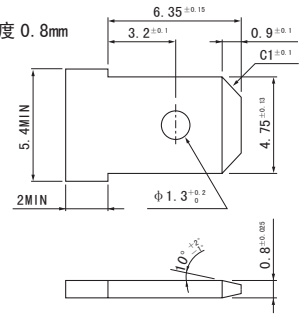

### #205

接片厚度 0.5mm

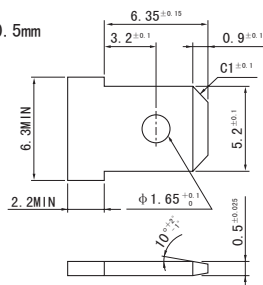

接片厚度 0.8mm

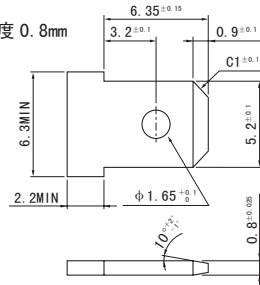

### #250

接片厚度 0.8mm

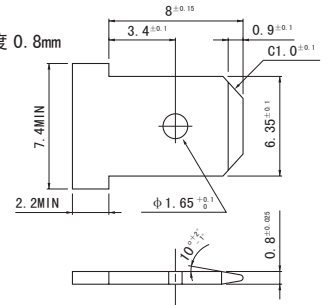

- 注 1) 作为微动开关使用时, 请垂询本公司。  
 2) 请注意接片表面不要有不需要的加强筋。  
 3) 材质请使用黄铜。  
 4) 使用 PS-187-4B 时, 请垂询本公司。